

# PARTS DETAILS

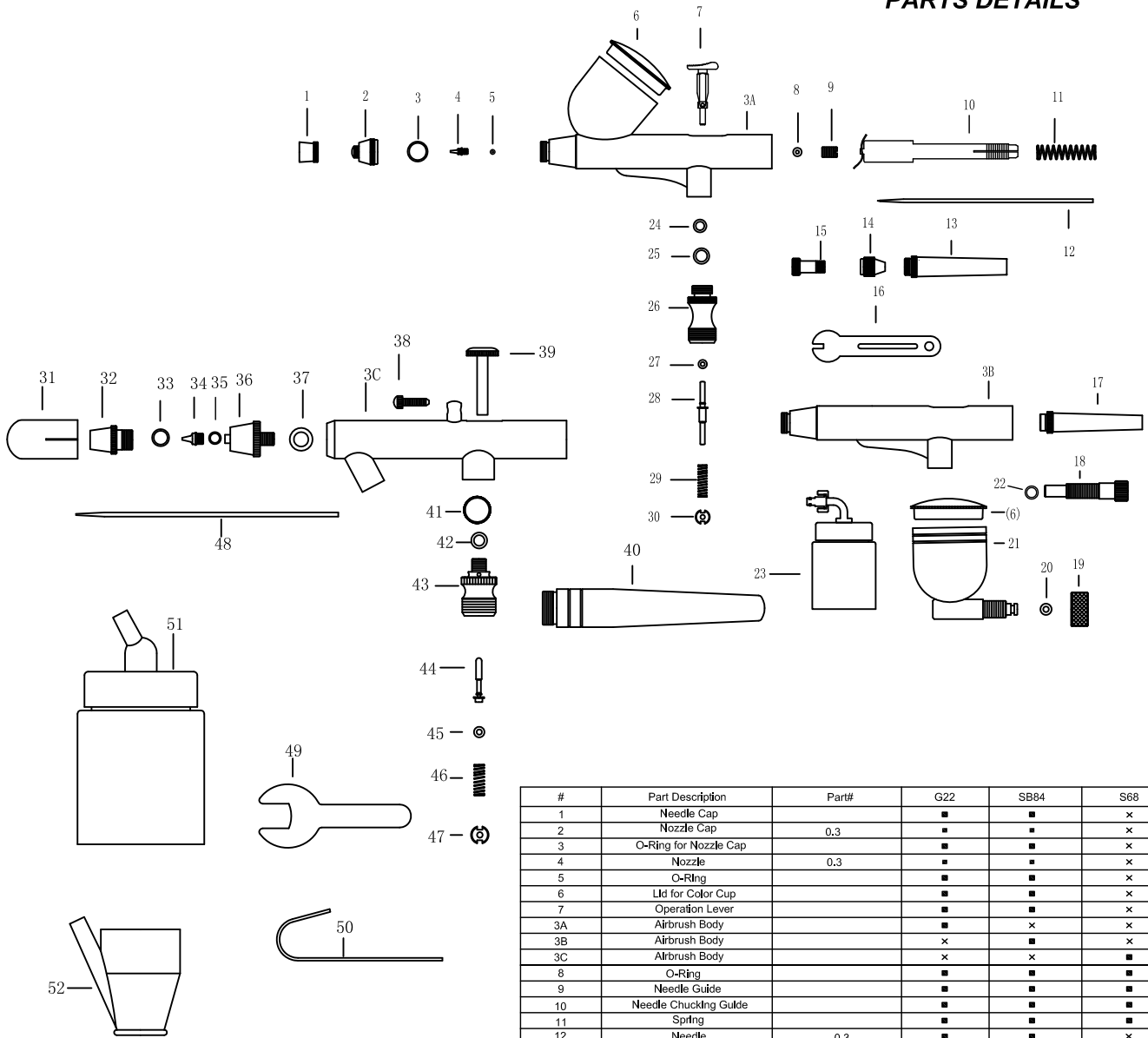

# S64

#	Part Description	Part#	G22	SB84	S68
1	Needle Cap		■	■	×
2	Nozzle Cap	0.3	■	■	×
3	O-Ring for Nozzle Cap		■	■	×
4	Nozzle	0.3	■	■	×
5	O-Ring		■	■	×
6	Lid for Color Cup		■	■	×
7	Operation Lever		■	■	×
3A	Airbrush Body			×	×
3B	Airbrush Body		×	■	×
3C	Airbrush Body		×	×	■
8	O-Ring		■	■	■
9	Needle Guide		■	■	■
10	Needle Chucking Guide		■	■	■
11	Spring		■	■	■
12	Needle	0.3	■	■	×
13	Standard-Handle Adjusting		■	×	×
14	Needle Chucking Net		■	■	■
15	Spring Case		■	■	■
16	Nozzle Spanner		■	■	×
17	Standard-Handle Adjusting		×	■	×
18	Adjusting Screw		×	■	×
19	Nut for color cup		×	■	×
20	O-Ring		×	■	×
21	Color Cup		×	■	×
22	O-Ring		×	■	×
23	Glass Jar		×	■	×
24	Lever Guide O-Ring		■	■	×
25	Valve O-Ring		■	■	×
26	Valve Body		■	■	×
27	Valve Rod O-Ring		■	■	×
28	Valve Rod		■	■	×
29	Valve Spring		■	■	×
30	Valve Screw		■	■	■
31	Protective Cap		×	×	■
32	Air Cap	0.5	×	×	■
33	O-Ring		×	×	■
34	Nozzle	0.5	×	×	■
35	O-Ring		×	×	■
36	Air Cap Body		×	×	■
3C	Airbrush Body		×	×	■
37	O-Ring		×	×	■
38	Adjustment Screw		×	×	■
39	Finger lever		×	×	■
40	Standard-Handle Adjusting		×	×	■
41	O-Ring		×	×	■
42	O-Ring		×	×	■
43	Valve Body		×	×	■
44	Valve Rod		×	×	■
45	Valve Rod O-Ring		×	×	■
46	Valve Spring		×	×	■
47	Valve Screw		×	×	■
48	Needle	0.5	×	×	■
49	Head Cap Spanner		×	×	■
50	Metal hanger		×	×	■
51	22 cc Glass jar assembly		×	×	■
52	5 cc Metal cup		×	×	■